

Christian Reid
Estate Agents



Cranleigh

£2,000pcm

Grange Park, Cranleigh, GU6 7HY



3 Bedrooms



1 Receptions



1 Bathrooms



EPC: D

A Spacious Detached Bungalow in a quiet Cul-de-sac | Located in a highly sought after area of Cranleigh | Three Double Bedrooms | Large Living Room | Brand New Kitchen Extension | New Bathroom Extension | Garage & Driveway | Large Private Rear garden | Neutral decor throughout | Available now | Unfurnished

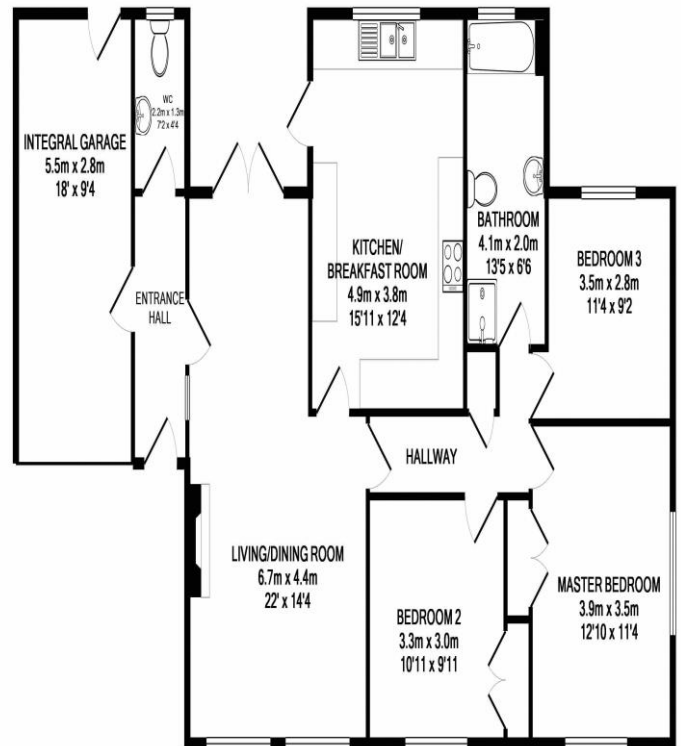

TOTAL APPROX. FLOOR AREA 114.2 SQ.M. (1229 SQ.FT.)
 Whilst every attempt has been made to ensure the accuracy of the floor plan contained here, measurements of doors, windows, rooms and any other items are approximate and no responsibility is taken for any error, omission, or mis-statement. This plan is for illustrative purposes only and should be used as such by any prospective purchaser. The services, systems and appliances shown have not been tested and no guarantee as to their operability or efficiency can be given
 Made with Metropro ©2018